

R3T-02

3kg Payload Industrial Robot Arm



Version 1.0.3
Copyright © 2018 by Robot3T

Parameters of the robot arm

Degree of freedom: 4

Payload: 3 kg

Repeat Positioning accuracy: $\pm 0.05\text{mm}$

Absolute Positioning accuracy: $\pm 0.4\text{mm}$

Joint velocity: $\pm 120^\circ/\text{s}$

Effective working radius: 650mm

Range of joints:

- Base Joint: $\pm 170^\circ$
- Shoulder Joint: $-90^\circ \rightarrow +75^\circ$
- Elbow Joint: $-90^\circ \rightarrow +75^\circ$
- Wrist Joint: $\pm 360^\circ$

Tool Speed: 500mm/s

Deadweight: 25kg

Communication: Modbus TCP/IP

Programming: Graphic User Interface(13.3 inch Teach Pendant)

Protection Level: IP54

Material: Aliminum Alloy, ABS Plastic

Temperature: 0-50 °C

Power: 100 - 220VAC, 50-60Hz

Power Consumption: 500W

Parameters of the teaching apparatus

Size: 350 x 210 x 40mm

Weight: 1600 gram

Display: 13.3 inch capacitive LCD

Connecting line length: 3.5m

Protection Level: IP54

Color: Blue, green or white



Parameters of the control box

Size: 500 x 500 x 500 mm

Weight: 30 kg

Color: white

Mitsubishi AC Servo Driver: 4

Communication: Modbus TCP/IP

Interface and openness: APIs for C\C++\C#

Power supply: 100 - 220VAC, 50-60Hz

Protection grade: IP54

I/O port

- Quantity input: 32
- Digital output: 32
- Analog input: 4
- Analog output: 4

Connection Robot and Connection Control box
wire: 6m



Range of movement

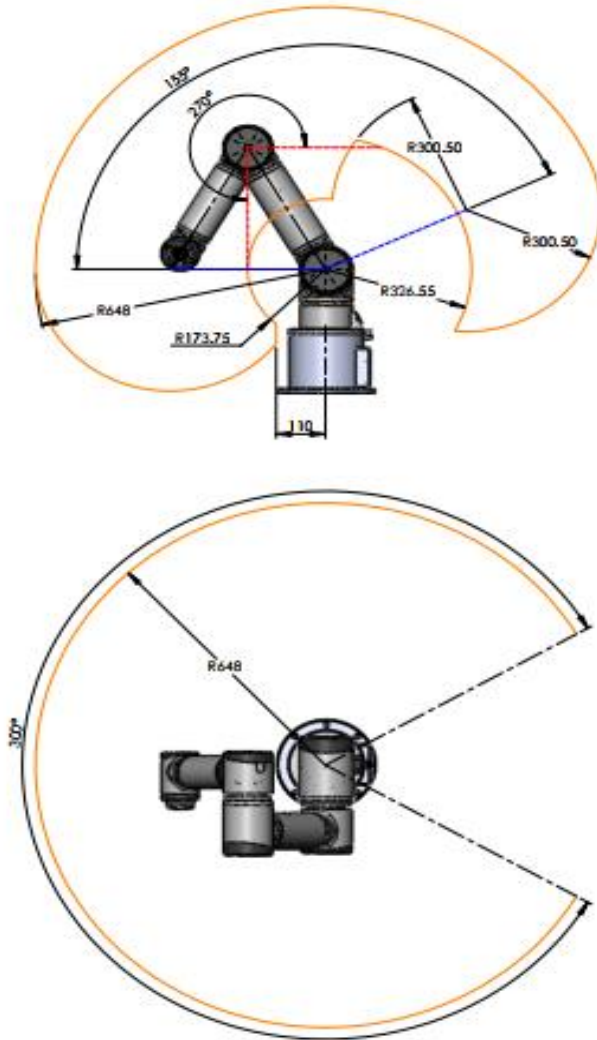

Output flange

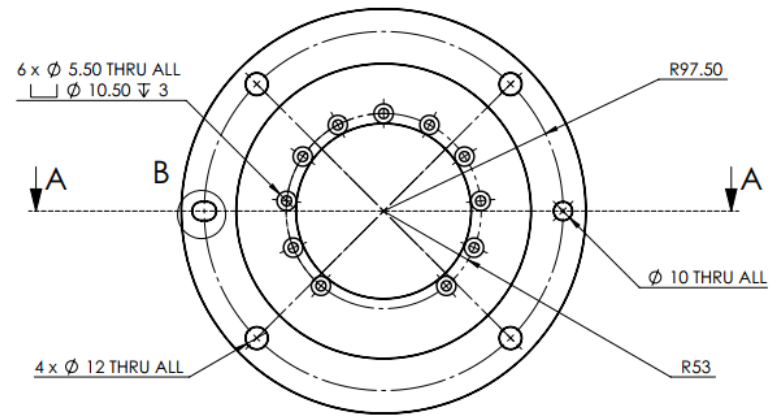

Robot Drawing

